

Technical features:

- steel towel warmer radiator
- horizontal elements featuring rectangular 50x10 mm section tubes
- side round manifolds with a 30 mm diameter
- manifold threading 1/2" Gas right
- maximum working pressure 4 bar
- maximum working temperature 95°C
- 50 mm connection
- hydraulic radiator equipped with a booster mounted behind the radiator with a power of 1,000 watts.
- not suitable for installation with a single-pipe system

Price included:

- 4 wall fixing in the same color as the radiator
- 2 1/2" hidden air vents complete with valve cover

| Finishes available | Surcharge |
|--------------------|-----------|
| Standard White | |
| Classic finished | |
| Special finished | |
| Other RAL colors | |

Finishing codes see page 596.



50 mm Connection

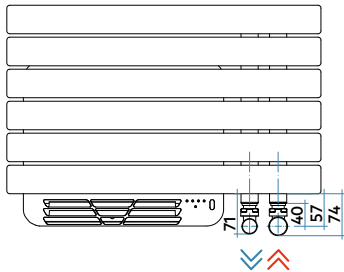

Type with collectors on the right
Hydraulic connection 50 mm

Connection dimensions with IRSAP valves

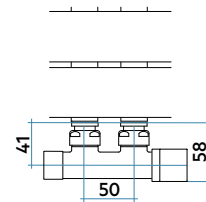

Booster



MAIN CHARACTERISTICS OF AIR DIFFUSER

- ON/OFF switch
- Power supply 230 V 50 Hz, 1 ph
- Power installed = 1000 W
- Insulation: CLASSE II
- Connecting to a network equipment that comes with the phase and neutral version without plug or with Schuko plug
- Protection index: IP24
- Long electricity cable: 1.200 mm
- Electronic ambient thermostat

SOUL_S AIR MIX

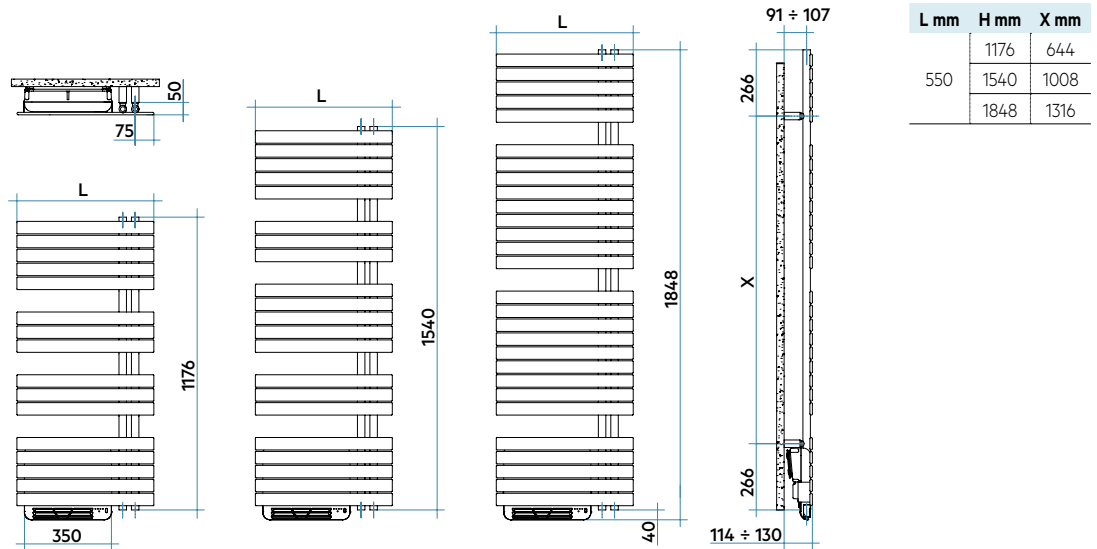

| Model | Code | Depth P mm | Height H mm | Width L mm | Conn. C. L' mm | Weight Kg | Cap. lt | Thermal Power | | | | Auxiliary heater | | |
|-------------------------------|------------------------------|---------------|----------------|---------------|-------------------|--------------|------------|--|---------------------------------------|---|---------------------------------------|------------------|-----------------------|--------|
| | | | | | | | | $\Delta t=50^{\circ}\text{C}$ Btu/h | $\Delta t=40^{\circ}\text{C}$ Watt | $\Delta t=30^{\circ}\text{C}$ Watt (*) | $\Delta t=20^{\circ}\text{C}$ Watt | Exp. n. | with diffuser Watt | |
| 1176 16 rails 3 espaces | UBS055 B 01 IR 01 NNN | 110 | 1216 | 550 | 50 | 13,9 | 4,1 | 1723 | 505 | 379 | 262 | 155 | 1,286 | + 1000 |
| 1540 21 rails 4 espaces | UBM055 B 01 IR 01 NNN | 110 | 1580 | 550 | 50 | 17,5 | 5,3 | 2235 | 655 | 491 | 338 | 200 | 1,295 | 1000 |
| 1848 28 rails 3 espaces | UBE055 B 01 IR 01 NNN | 110 | 1888 | 550 | 50 | 21,9 | 7,3 | 2815 | 825 | 616 | 423 | 248 | 1,310 | 1000 |

(*) Thanks to the high performance of Irsap SOUL_S AIR MIX radiators, the ideal Δt for low temperature projects is Δt at 30°C .
For Δt different from 50°C use the formula: $Q=Q_n (\Delta t / 50)^n$

Key Codes

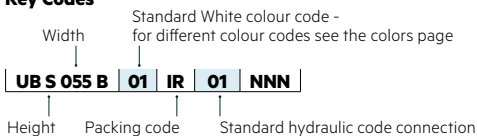

BATHROOMS
RADIATORS

Decorative & Technical Accessories

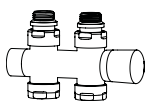

Kit Valves and
Lockshield valve
Pag. 562

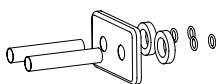

Pipe cover kit
Pag. 566

Wireless Remote Control (optional) for booster control

SOUL_S Air Mix is equipped with a controller that allows remote management of every electric radiator function. Because the controller is wireless, it has the advantage of being quick and easy to install and does not require any modifications within the home.

REELETRAS2501N

Technical specifications

- Wireless communication via radio signals transmitted to the receiver connected to the system.
- Approx. 30-50 metre range in residential environments (868 MHz).
- Radiofrequency communication pursuant to European standards.
- You can activate the manual functions

